



The Castle Partnership Trust

ACHIEVE | BELONG | PARTICIPATE



Isambard Kingdom Brunel Primary School

Our aim is for every child to achieve, participate and belong, and this is at the heart of everything we do at The Castle School Partnership Trust

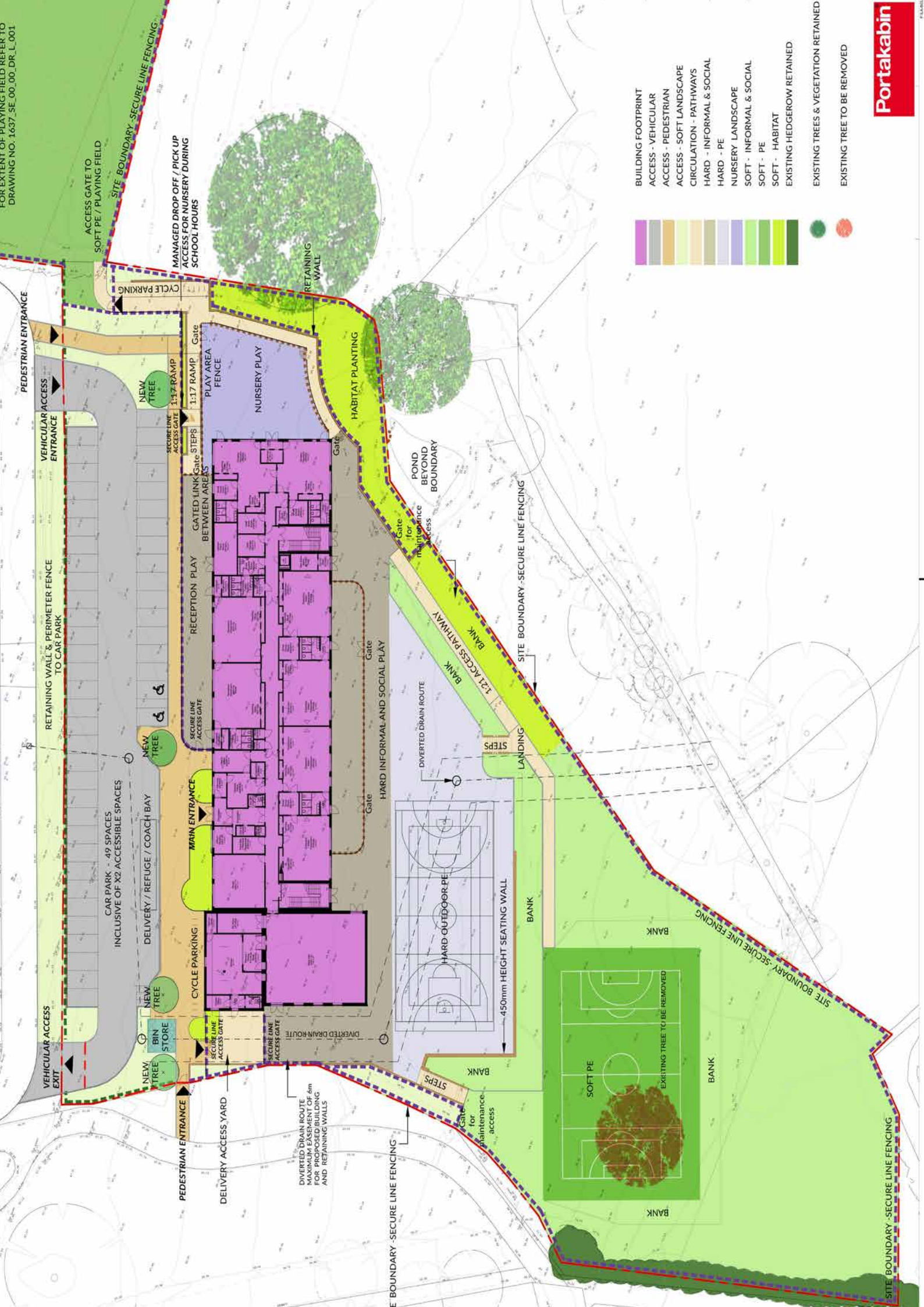

Isambard Kingdom Brunel (IKB)

Primary School

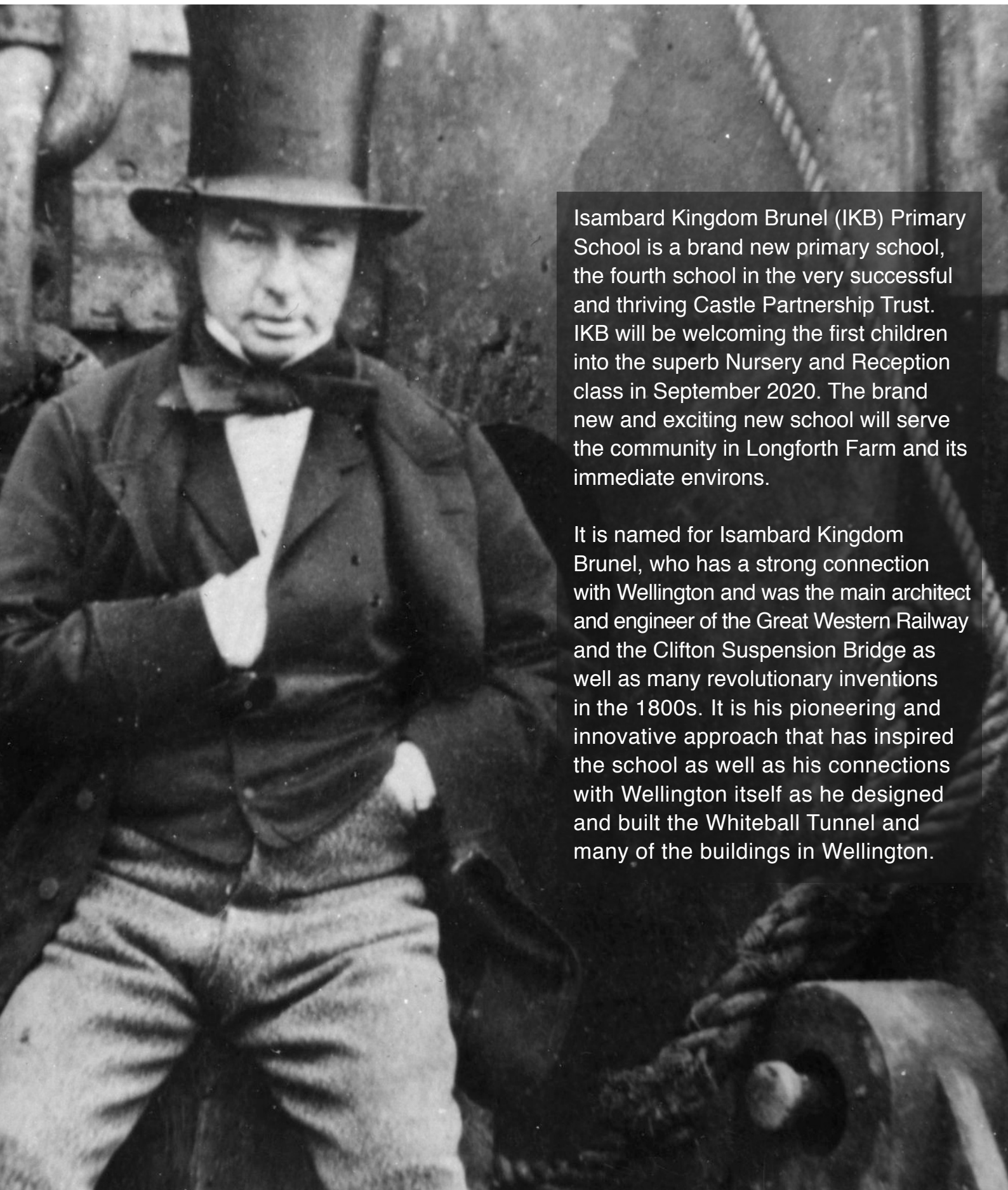

Isambard Kingdom Brunel (IKB) Primary School is a brand new primary school, the fourth school in the very successful and thriving Castle Partnership Trust. IKB will be welcoming the first children into the superb Nursery and Reception class in September 2020. The brand new and exciting new school will serve the community in Longforth Farm and its immediate environs.

It is named for Isambard Kingdom Brunel, who has a strong connection with Wellington and was the main architect and engineer of the Great Western Railway and the Clifton Suspension Bridge as well as many revolutionary inventions in the 1800s. It is his pioneering and innovative approach that has inspired the school as well as his connections with Wellington itself as he designed and built the Whiteball Tunnel and many of the buildings in Wellington.

The Castle Partnership Trust



The Castle Partnership Trust is The Castle School, Court Fields, Wellesley Park and IKB. It is founded on the principles of giving every child in our local community the very highest quality education, to see themselves as successful, to participate in enrichment and learning and to be full citizens locally, national and globally. IKB will have at its core the Trust's commitment that:

- Every Child Achieves
- Every Child Belongs
- Every Child Participates in learning, enrichment and the community

The Castle Partnership Trust is committed to the principle that every child will feel a sense of belonging and that they are important and contribute in their own unique way as well as collectively building a positive, enthusiastic and supportive community that is based on mutual respect and support. There is assumed success throughout The Castle Partnership Trust.

The Trust believes strongly in the community, and the contribution that young people make is essential to the wellbeing of their local, national and global community.

We have taken Isambard Kingdom Brunel as the inspiration for our character education programme which has three strands:



Resilience, Reflection and Health and Wellbeing.

IKB will centre itself firmly in the heart of local community and support the community by ensuring pupils have a clear sense of what makes a good citizen and a good neighbour, the responsibilities and the privilege of living in the UK. Pupils will have a strong sense of themselves in the local, national and global context so that they have clear sense of the responsibility they have to others, in the present and in the future.

Bright Sparks Nursery



‘Every child deserves the best possible start in life and the support that enables them to fulfil their potential. Children develop quickly in the early years and a child’s experiences between birth and age five have a major impact on their future life chances. A secure, safe and happy childhood is important in its own right. Good parenting and high quality early learning together provide the foundation children need to make the most of their abilities and talents as they grow up.’



The Early Years provision at the new school will ensure that children become confident and capable in a safe, healthy and enabling environment. The characteristics of effective learning at the core of Bright Sparks will ensure children’s ‘school readiness’ and gives children the broad range of knowledge and skills that provide the right foundation for good future progress through school and life.



Parents



The Sutton Trust recognizes the long term impact of 'developing secure attachments between child and parent.' The schools and Trust are key supporters for parents in helping them to bring up their children to be positive, successful and healthy citizens who contribute and participate positively to the community and economy.

To support families, the nursery will:

- Appoint key workers whose responsibility is to be the direct link between family and nursery.
- Give parents the chance to join their children in Play Workshops so that families can play constructively and creatively with their child/ren, learning from experts and working with their children's teachers so that we know your child well and can provide the very best for them.

The key person for every child will maintain the stability of that relationship as a priority. We will encourage parents to be highly involved in their child's education.

The Trust is absolutely committed to supporting parents in bringing up their children the best they possibly can and will do all it can to help parents by providing expertise and support, helping new parents to be the best they can be. We will build effective and positive relationships with health professionals and other agencies so that a child's needs are quickly identified and planning takes place to ensure their progress. For the Trust, this is the first of a 14-year relationship and it is essential that we get this right and ensure that parents understand that we are helping them bring up their child/ren.



Children's Health and Wellbeing



Great attention is paid to Health and Wellbeing as one of the key factors in the decision of the Trust to open primary schools so that we can establish the foundation for exemplary learning and achievement, personal development and wellbeing at the earliest possible opportunity.

Health and wellbeing is provided through the ethos of the Trust, through its focus on resilience and good mental health, in developing physical confidence and healthy lifestyles through Sport and PE as well as Dance and Drama. Physical health will be developed by high levels of physical activity, developing independent self-care routines and healthy eating. Equally important is emotional wellbeing so that children learn about feeling and emotions, and develop their empathy and imagination.

- Every child is a unique child, who is constantly learning and can be resilient, capable, confident and self-assured;
- Children learn to be strong and independent through positive relationships;
- Children learn and develop well in enabling environments, in which their experiences respond to their individual needs and there is a strong partnership between practitioners and parents and/or carers; and
- Children develop and learn in different ways and at different rates. The framework covers the education and care of all children in early years provision, including children with special educational needs and disabilities.



The Isambard Kingdom Brunel School

The Trust strives to ensure that every single child in our care achieves, belongs and participates in learning, enrichment and the community.

Pastoral support is exemplary in ensuring that barriers to learning are removed, that children participate and feel valued for their own intrinsic worth.

Early Years provision will form the bedrock of our children's outstanding education and personal development. Children will leave Reception class with a sense of themselves as both individuals, and as part of their own community.

Kindling the interest and igniting the spark of enthusiasm is the key to engendering real learning, and securing children's commitment to their own learning is a vital part of our vision. In The Castle Partnership Trust we work for the children; they know this, and we foster the belief that they work for themselves and not to please their teachers.

Every child will be taught literacy and English, numeracy and mathematics, Science and STEM including programming/coding/computing and Design technology, Humanities, Languages, the Arts including Art and Design, Health and Wellbeing including PE and Sports. There will be a strong emphasis on developing competency and mastery of basic core skills in English and Mathematics as well as PSHE and citizenship. Whilst the core subjects will be taught explicitly other subjects will be taught through project and topic based curriculum to ensure that skills are embedded and that children learn deeply and have mastery of skills.

Science and STEM (Science, Technology, Engineering and Mathematics) will be a key feature of the Isambard Kingdom Brunel School. Children are naturally curious and excited by new things and we will harness and stimulate that energy so that every child becomes a scientist in the way that they are mathematicians. We will emphasise the interdependence of the STEM subjects and excite children through hypothesis, experimentation and scientific enquiry. We will follow the National Curriculum for Science but in addition to this, children will be strongly encouraged to pursue scientific enquiries of their own and teachers will be expected to stimulate children's curiosity and to very actively plan to develop the interests of the children they teach.



The Brunel Programme

In addition to this but integral to our curriculum is The Brunel Programme, our character education programme:

- Resilience through STEM activities, experimentation and planned failure to learn
- Reflection through the Arts and Philosophy
- Health and Wellbeing through Sport and Expeditions

Children will be encouraged to develop as rapidly as is right for them; gifted and talented children will be encouraged, for example, to read beyond the age-related range of reading materials and to explore challenging books and ideas. In Maths, the most able will be encouraged to explore mathematical problems, to stretch themselves beyond the age-related curriculum and to approach work in different ways, finding different solutions. All pupils will be taught to develop their capacity for creative thinking and expression through Music, Art, Dance and Drama.

The Trust's vision that Every child achieves, belongs and participates in learning, enrichment and the community is overarching.



Parents - Building strong relationships



Building on the strong relationship we will have built with the Nursery, we will continue with the same system in the primary school. The school is a key support for parents in bringing up their child/ren and as a school, we will advocate the values and principles that we have embedded in our curriculum so that parents are strengthened and informed about parenting and how to support their child best.

Special Educational Needs

The Trust has a deep commitment to ensuring that every child in the Trust achieves, belongs and participates. To that end there is a trust SEN team which is focused on every child with SEN. The team is developing expertise in a wide range of particular needs so that every child's needs are met.



Health and Wellbeing

This is a crucial part of our curriculum. This covers Sports and PE, Food and Health, PSHE and Philosophy for Children.

Through Sports and PE children will develop physically and learn teamwork, healthy competition, failing and losing and learning – a key part of our character education.



At Key Stage 1, children will develop fundamental movement skills and coordination. They will be coached in improving such motor skills so they become agile and coordinated which will positively affect their ability to learn writing and to manipulate tools etc. as well as increasing agility, balance and coordination. Dance will not be part of the PE curriculum as it is part of the Arts at the Trust, however it clearly contributes to physical skills developed through PE and Sports.



Enrichment and Extra Curricular Activities

Enrichment is a feature of the Trust and all staff are expected to deliver enrichment programmes to bring the subject to life and to foster a love and thirst for learning. Children at the Trust have a very high expectation of their teachers and this will be no different at IKB. All teachers will be expected to run enrichment and after school clubs.

At the Isambard Kingdom Brunel School, enrichment will be a feature as it is at the lead sponsor school. Music, Dance, Drama, Art and Design will feature prominently alongside Sports and Science. Trips and expeditions will be a feature and support resilience so that children regularly overcome obstacles or are challenging their fixed mind-set and changing their beliefs about what they can and can't do. Children will not say, "I can't", but "I can't yet - what do I need to do differently or learn so that I can?"





The Castle Partnership Trust
ACHIEVE | BELONG | PARTICIPATE